

PRODUCT CATALOG

- ▶ Lead-Free Service Brass
- ▶ Lead-Free Meter Brass
- ▶ Machine Shop Services
- ▶ Space Saver Flanges
- ▶ Pipe Supports
- ▶ Custom Parts

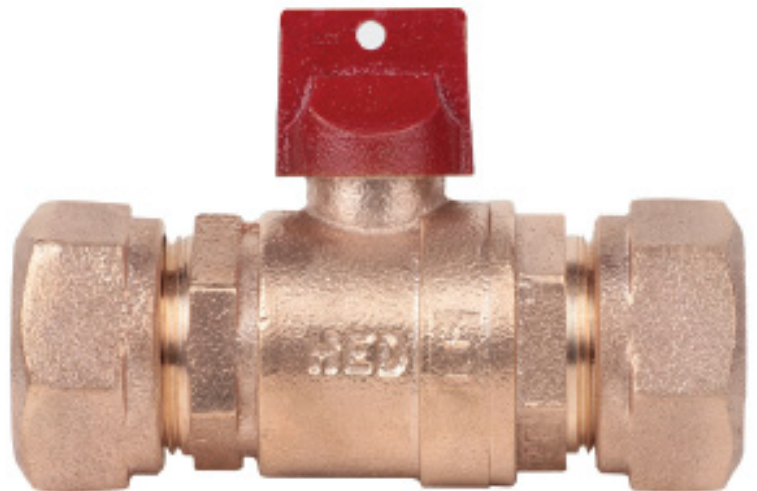

HISTORY

The history of Red Hed goes back to 1921 with its beginning in South Boston, Massachusetts.

From manufacture of the very first valve, through 1970 when the company was first sold, each valve was hand wrapped in brown mill paper and boxed in wood packing boxes for shipment. Each handmade valve was assembled and tested before ever leaving the production floor. To distinguish itself from its competitors' the head of each valve was painted red, thus the name Red Hed Manufacturing. To this day Red Hed continues the tradition started in 1921 of manufacturing the finest brass waterworks valves and components in our industry.

Henry Lawton (owner of Lawton Manufacturing) purchased Red Hed in 1970 and it was merged with his company. He moved Red Hed from Boston to its current location in Rhode Island where the company continued to fabricate Red Hed brass waterworks valves in the same manner as its predecessors. Henry focused his efforts on the Red Hed product line and over the next few decades the company became known for its innovative designs and quality craftsmanship.

Having a reputation as a leader in adaptation and producing valves that just did not fail in the field allowed Red Hed to grow and prosper. The invention and patenting of the Space

Saver flange opened new markets for Red Hed. The firm continued to grow, selling Red Hed product lines throughout the United States and Canada. In 2006, Red Hed demonstrated that its creativity continues by introducing the first line of true Lead-Free brass products. The small shop has grown and now enjoys the reputation for fast turn-around and the same great quality.



Red Hed's reputation for the best brass valve in the industry remains intact. The spirit of past owners, engineers and machinists who took great pride in their work, is proudly continued by our strong work ethic and integrity: "It doesn't leave the plant until it is 100%." Red Hed has adapted, evolved and met the challenges of the various generations. We look forward to the next 90 years being just as challenging and rewarding as the first 90 years.

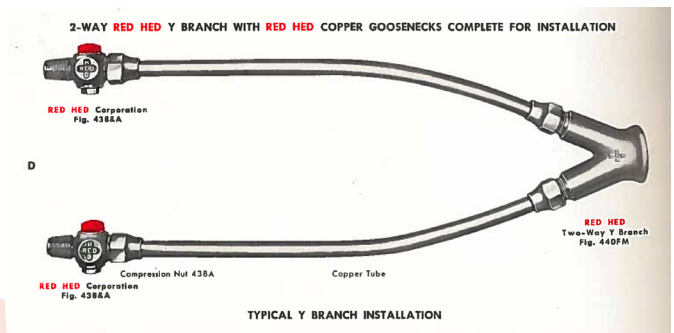
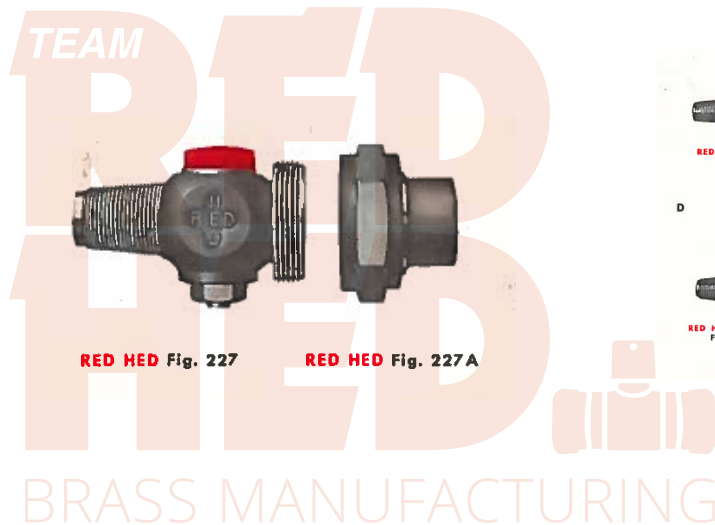

TABLE OF CONTENTS

Corporation Stops

Red Hed Ball Corporation Stops.....	1
AWWA (CC) x Compression.....	1
Iron Pipe (IP) x Compression	1
AWWA (CC) x Flare.....	1
Iron Pipe (IP) x Flare	1

Ball Curb Stops

Compression x Compression	2
Compression x Female Iron Pipe	3
Female Iron Pipe x Female Iron Pipe	4
Flare x Flare.....	5

Brass Fittings

Male Adaptors - Compression x Male Iron Pipe.....	6
Male Adaptors - Flare x Male Iron Pipe	6
Female Adaptors - Compression x Female Iron Pipe.....	7
Female Adaptors - Flare x Female Iron Pipe.....	7
Red Hed Couplings - Compression x Compression	8
Red Hed Couplings - Flare x Flare.....	8

Lead Flange Adaptors

9

Meter Hardware

Bronze Meter Flanges	10
Downsizing Hardware	10

Space Saver Flanges

11

Pipe Supports

Redi-Jack Pipe Support	12
------------------------------	----

Services

Rebuilding Drilling & Tapping Machines.....	12
Machine Shop Capabilities & Service.....	13
Sharpening Drill Bits.....	13
Machine Shop Capabilities.....	14

TERMS & CONDITIONS

Prices: All Prices are subject to change without notice, except where firm quotations have been provided in writing by authorized management personnel of RED HED.

Taxes: Prices do not include any present or future federal, state, or local taxes (including, without limitation, sales tax, use tax, excise tax, or otherwise) unless specifically stated. It is the responsibility of the Buyer to pay all such taxes. Taxes where applicable may be added to the price of the products and shall be paid by the Buyer, unless the Buyer furnishes to RED HED a tax exemption certificate in a form agreeable to the applicable taxing authorities. If RED HED is required to prepay and such tax, Buyer will reimburse RED HED in full upon demand.

Payment Terms: RED HED Open Credit accounts are established for commercial, non-consumer use only. Unless an approved commercial Open Credit account is established, payment in good funds or approved check must be made before or at time of delivery. Commercial Credit terms are Net 30 days, no cash discounts allowed. Service Charges commence after 30 days and are calculated on the last day of the month in which the 30th day falls. SERVICE CHARGE IS 1½% PER MONTH (18% A.P.R.) ON THE BALANCE OVER 30 DAYS OF AGE. THE BUYER AGREES TO PAY ALL COSTS AND EXPENSES OF COLLECTION, INCLUDING REASONABLE ATTORNEY'S FEES, and RED HED claims a mechanic's lien under applicable state law.

Acceptance by RED HED: All orders from the Buyer are subject to acceptance by authorized personnel of RED HED, and, in the case of Open Account Sales, approval of the RED HED Credit Department.

Cancellations: SPECIAL OR NON-STOCK ITEMS MAY NOT BE CANCELLED OR RETURNED AFTER THE PRODUCT(S) IS PLACED INTO PRODUCTION. All charges and cost incurred by RED HED as a result of cancellations or order changes will be billed to the Buyer.

Delivery: RED HED will make a good faith effort to complete delivery of the products, provided, however, that RED HED assumes no responsibility or liability for loss or damage due to delay or inability to deliver, if such non-performance was the result of any events or circumstances beyond the control of RED HED, including, but not limited to, acts of God, war, labor difficulties, fire, accidents, inability to obtain materials, and delays of carriers, contractors, suppliers, or manufacturers. Under no circumstances shall RED HED be liable for any special, consequential, incidental, indirect, or liquidated damages, losses, or expense (whether or not based on negligence) arising directly or indirectly from delays or failure to give notice of delay.

Shipment: Shipment of all products is to one given destination for all items including pipe, unless otherwise indicated in writing. Risk of loss shall transfer to the Buyer upon tender of goods to Buyer, Buyer's representative, or common carrier. The cost of any special packing or special handling caused by Buyer's requirements or requests shall be added to the amount of the order. If Buyer causes or requests a shipment delay, or if RED HED ships or delivers the products erroneously as a result of inaccurate, incomplete or misleading information supplied by Buyer or its agents or employees, storage and all other additional costs and risks shall be borne solely by Buyer. Claims for products damaged or lost in transit should be made by Buyer to the carrier, as RED HED's responsibility ceases upon tender of goods to Buyer, Buyer's representative or common carrier. Delivery will be made on hard surfaces only. Any damage or towing charges resulting from "non-hard surface deliveries" shall be the responsibility of the buyer.

Inspection and Acceptance: Claims for damage, shortage or errors in shipping must be reported within 10 days following delivery to Buyer. Buyer shall have 10 days from the date Buyer receives any products to inspect such products and services for defects and nonconformance and notify RED HED, in writing, of any

defects, nonconformance or rejection of such products. After such 10 day period, Buyer shall be deemed to have irrevocably accepted the products, if not previously accepted. After such acceptance, Buyer shall have no right to reject the products for any reason or to revoke acceptance. Buyer hereby agrees that such 10 day period is a reasonable amount of time for such inspection and revocation.

Returns: Materials cannot be returned without RED HED's written consent. NO RETURNS ARE ALLOWED AND NO REFUNDS WILL BE MADE ON (i) PIPE OR (ii) SPECIALLY FABRICATED OR ORDERED ITEMS. THE SOLE AND EXCLUSIVE REMEDY FOR SUCH ITEMS ALLEGED TO BE DEFECTIVE IN WORKMANSHIP OR MATERIAL WILL BE THE RE-PLACEMENT OF THE ITEMS SUBJECT TO THE MANUFACTURER'S INSPECTION AND WARRANTY. All other returned material is subject to a MINIMUM 25% RE-HANDLING CHARGE, plus transportation charges. Unless otherwise agreed by the Buyer and RED HED, all credit for returned material will be applied to future orders, subject to approval by the RED HED Credit Department.

Warranty: THE BUYER'S SOLE AND EXCLUSIVE WARRANTY, IF ANY, IS THAT PROVIDED BY THE PRODUCT'S MANUFACTURER. RED HED MAKES NO EXPRESS OR IMPLIED WARRANTIES. RED HED HEREBY DISCLAIMS ALL EXPRESS OR IMPLIED WARRANTIES, WHETHER IMPLIED BY OPERATION OF LAW OR OTHERWISE, INCLUDING, WITHOUT LIMITATION, ALL IMPLIED WARRANTIES OF MERCHANTABILITY AND FITNESS OR FITNESS FOR A PARTICULAR PURPOSE. UNDER NO CIRCUMSTANCES, AND IN NO EVENT, WILL RED HED BE LIABLE FOR PERSONAL INJURY OR PROPERTY DAMAGE OR ANY OTHER LOSS, DAMAGE, COST OR REPAIRS OR INCIDENTAL, PUNITIVE, SPECIAL, CONSEQUENTIAL, OR LIQUIDATED DAMAGES OF ANY KIND, WHETHER BASED UPON WARRANTY, CONTRACT, STRICT LIABILITY, NEGLIGENCE OR ANY OTHER CAUSE OF ACTION ARISING IN CONNECTION WITH THE DESIGN, MANUFACTURE, SALE, TRANSPORTATION, INSTALLATION, OR REPAIR OF THE PRODUCTS SOLD BY RED HED. BUYER ACKNOWLEDGES AND AGREES THAT UNDER NO CIRCUMSTANCES, AND IN NO EVENT, SHALL RED HED'S LIABILITY, IF ANY, EXCEED THE NET SALES PRICE OF THE DEFECTIVE PRODUCT(S).

Entire Agreement: This document constitutes the entire, complete, and exclusive agreement between the parties with respect to the subject matter hereof and contains all the agreements and conditions of sale; no course of dealing or usage of the trade shall be applicable unless expressly incorporated herein. The terms and conditions contained herein may not be added to, modified, superseded or otherwise altered except by a written modification signed by authorized management personnel of RED HED. All transactions shall be governed solely by the terms and conditions contained herein. All purchase orders issued pursuant to a RED HED quotation shall be deemed issued subject to all RED HED terms and conditions herein contained. These terms and conditions shall supersede those of the Buyer.

Governing Law: This transaction shall be governed in all respects by the laws of the State of Maine (excluding choice of law provisions). All actions, regardless of form, arising out of or in connection with this transaction, the products sold by RED HED, or the relationship between the Buyer and RED HED shall be brought in the courts of the State of Maine within the applicable statutory period.

Communications: Payments only should be directed to: RED HED MANUFACTURING, P.O. Box 350002, Boston, MA 02241-0502. All other correspondence and inquiries should be directed to your local RED HED Division. The Home Office address is 32 Prescott Street, P.O. Box 600, Gardiner, ME 04345. Telephone (207) 582-1851. Fax (207) 582-5637. E-mail ejp@ejprescott.com.

EJP T&C Revision Date 4/09

LEAD FREE BRASS WATER SERVICE PRODUCTS

The Flagship of Red Hed Manufacturing continues to be our Brass Product line! With a variety of Corporations, Curb Stops, Meter Flanges and Adapters, we offer both diverse and practical components that are used in the Waterworks Industry. Red Hed lead-free brass allows you to install and fulfill your customer's needs in nearly every application. From pouring our castings to machining and testing our finished products, each process takes place here in the USA.

Corporation Stops

Essential to every small water service, we offer 3/4" to 2" sizes for direct and saddle taps on water mains. Available in AWWA (CC) thread or iron pipe (MIP) thread inlet, and compression or flare end outlet configurations. Our Corps are 360° open/close operation for slimline design. Manufactured to the latest AWWA C800 standards.

Curb Stops

Available in a variety of end configurations, sizes 3/4" to 2". Curb Stops are either 1/4 turn open left (counter clockwise) or right (clockwise). Essential to every small water service, the curb stop is typically the only valve between a water district and it's customer. Manufactured to the latest AWWA C800 standards.

Brass Fittings

Red Hed fittings for copper service tube and polyethylene tubing are carefully designed with installation in mind, manufactured and tested for long, dependable service. We offer compression and flare couplings and adapters, sizes 3/4" to 2".

Lead Flange Adaptors

Red Hed Lead Flange Adaptors are custom made adaptors that allow the use of existing corporations and eliminate retapping or line shutdowns. They're available from 5/8" to 2" lead service. Some common sizes are in stock, while most will require a sample in order to ensure you get the correct adapter.

Meter Downsizing Hardware

A full line of pre-engineered parts to downsize large water meters to smaller ones. Manufactured conforming to AWWA C800 standards while adapting to standard lay lengths of your AWWA C700 standard water meters.

TUBING OUTSIDE DIAMETERS		1/2"	3/4"	1"	1 1/4"	1 1/2"	2"
CTS Plastic or Copper Tubing	O.D.	.625	.875	1.125	1.375	1.625	2.125

MAXIMUM DRILL SIZE USED WITH BALL CORPORATIONS						
Corporation Stop Size	3/4"	1"	1 1/4"	1 1/2"	2"	
Maximum Drill Size	11/16"	7/8"	1 3/16"	1 7/16"	7/8"	

CORPORATION STOPS

Red Hed Ball Corporations

Red Hed ball corporations are machined to ensure water-tight integrity. They have full-size waterways and heavy castings manufactured from lead free bismuth brass CDA No. C89833. During the manufacturing process, the valves are repeatedly inspected and hydrostatically tested to 300 psi.



Features:

- Manufactured to ANSI/AWWA C800 Standards
- 80 durometer Neoprene rubber seats that seal in both directions
- Full port clear waterway in all sizes
- Double “O” ring stem seals
- Coated ball for easy turning, PTFE coated
- 360-degree open/close operation
- Available with and without tee-head
- Inlet options: AWWA (CC) thread or Male Iron Pipe (MIP) Thread
- Outlet options: Compression, Flare, Female Iron pipe (FEIP), Male Iron Pipe (MIP)
- All components of the valve manufactured from Lead Free Brass, Casting stamped “LF”
- Compression Outlet threads CST Copper Service Thread, making it compatible with all the industry standard drilling and tapping machines
- All Cast components poured and manufactured in the USA.
- Easy to install compression or flare outlet (industry standards).

AWWA (CC) or Iron Pipe (IP) x Compression

PRODUCT NUMBER	SIZE	TYPE OF PIPE	INLET	OUTLET
RHSB43821	¾"	Copper Service Tubing or Poly Tubing	¾" AWWA Tapered	¾" Compression
RHSB43822	1"	Copper Service Tubing or Poly Tubing	1" AWWA Tapered	1" Compression
RHSB43824	1½"	Copper Service Tubing or Poly Tubing	1½" AWWA Tapered	1½" Compression
RHSB43825	2"	Copper Service Tubing or Poly Tubing	2" AWWA Tapered	2" Compression
RHSB43831	¾"	Copper Service Tubing or Poly Tubing	¾" Iron Pipe	¾" Compression
RHSB43832	1"	Copper Service Tubing or Poly Tubing	1" Iron Pipe	1" Compression
RHSB43834	1½"	Copper Service Tubing or Poly Tubing	1½" Iron Pipe	1½" Compression
RHSB43835	2"	Copper Service Tubing or Poly Tubing	2" Iron Pipe	2" Compression
RHB43804	1½"	Copper Service Tubing or CTS PE Tubing	1½" AWWA Taper	1½" Flare
RHB43805	2"	Copper Service Tubing or CTS PE Tubing	2" AWWA Taper	2" Flare
RHB43814	1½"	Copper Service Tubing or CTS PE Tubing	1½" Iron Pipe	1½" Flare
RHB43815	2"	Copper Service Tubing or CTS PE Tubing	2" Iron Pipe	2" Flare

NOTE: Stainless steel insert stiffeners are required for use with plastic tubing (CTS) (compression ends only). For use on soft K copper tubing and CTS plastic only.

COMPRESSION CURB STOPS

Red Hed Ball Curb Stops

Red Hed Ball Curb Stops are precision machined to ensure watertight integrity. They have full-size waterways and heavy castings. They are manufactured from lead-free bismuth brass CDA No. C89833. During the manufacturing process, the valves are repeatedly inspected and hydrostatically tested to 300 psi.

Features:

- Manufactured to ANSI/AWWA C800 Standards
- 80 durometer Neoprene rubber seats that seal in both directions
- Full port clear waterway in all sizes
- Double “O” ring stem seals
- Full lead free brass ball, teflon coated for easy turning
- Open left or right, ¼ turn operation with stop, clearly marked T-head L or R
- Tee-Head Secured with Stainless steel retaining pin (¾" - 1" only)

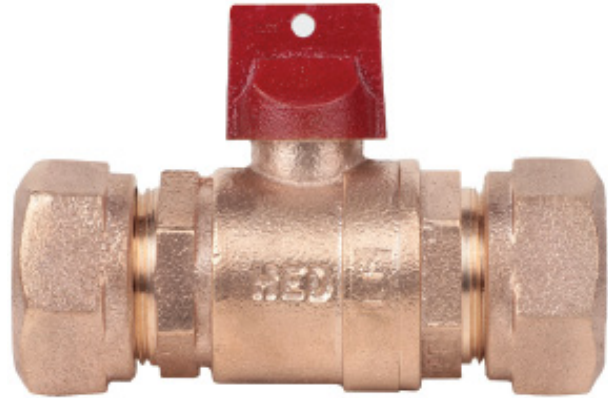

- All components of the valve manufactured from Lead Free Brass, Casting Stamped “LF”
- Dovetail stem and ball design (1¼"-2")
- All Cast components poured and manufactured in the USA.
- Easy to install compression or flare outlet (industry standards)
- Suitable for use on copper service tubing or CTS PE tubing.

Compression x Compression

PRODUCT NUMBER	SIZE	DIRECTION TO OPEN	INLET	OUTLET
RHSB41511	¾"	LEFT (counterclockwise)	¾" Compression	¾" Compression
RHSB41512	1"	LEFT (counterclockwise)	1" Compression	1" Compression
RHB41513	1¼"	LEFT (counterclockwise)	1¼" Compression	1¼" Compression
RHB41514	1½"	LEFT (counterclockwise)	1½" Compression	1½" Compression
RHB41515	2"	LEFT (counterclockwise)	2" Compression	2" Compression
RHSB41611	¾"	RIGHT (clockwise)	¾" Compression	¾" Compression
RHSB41612	1"	RIGHT (clockwise)	1" Compression	1" Compression
RHB41613	1¼"	RIGHT (clockwise)	1¼" Compression	1¼" Compression
RHB41614	1½"	RIGHT (clockwise)	1½" Compression	1½" Compression
RHB41615	2"	RIGHT (clockwise)	2" Compression	2" Compression

NOTE: Stainless steel insert stiffeners are required for use with plastic tubing (CTS) (compression ends only).
 Optional handle available for above ground operation.
 For use on soft K copper tubing and CTS plastic only.

COMPRESSION X FEMALE CURB STOPS

Red Hed Ball Curb Stops

Red Hed Ball Curb Stops are precision machined to ensure watertight integrity. They have full-size waterways and heavy castings. They are machined from lead-free bismuth brass CDA No. C89833. During the manufacturing process, the valves are repeatedly inspected and hydrostatically tested to 300 psi.

Features:

- Manufactured to ANSI/AWWA C800 Standards
- 80 durometer Neoprene rubber seats that seal in both directions
- Full port clear waterway in all sizes
- Double “O” ring stem seals
- Full lead free brass ball, teflon coated for easy turning
- Open left or right, ¼ turn operation with stop, clearly marked T-head L or R
- Tee-Head Secured with dovetail stem and ball design
- All components of the valve manufactured from Lead Free Brass, Casting Stamped “LF”
- All Cast components poured and manufactured in the USA.
- Easy to install compression end.

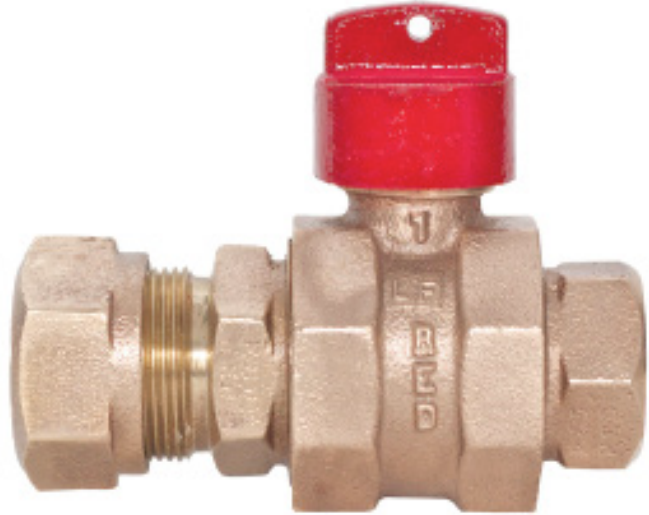

Compression x Female Iron Pipe

PRODUCT NUMBER	SIZE	DIRECTION TO OPEN	INLET	OUTLET
RHB40811	¾"	LEFT (counterclockwise)	¾" Compression	¾" Female Iron Pipe
RHB40812	1"	LEFT (counterclockwise)	1" Compression	1" Female Iron Pipe
RHB40813	1¼"	LEFT (counterclockwise)	1¼" Compression	1¼" Female Iron Pipe
RHB40814	1½"	LEFT (counterclockwise)	1½" Compression	1½" Female Iron Pipe
RHB40815	2"	LEFT (counterclockwise)	2" Compression	2" Female Iron Pipe
RHB40911	¾"	RIGHT (clockwise)	¾" Compression	¾" Female Iron Pipe
RHB40912	1"	RIGHT (clockwise)	1" Compression	1" Female Iron Pipe
RHB40913	1¼"	RIGHT (clockwise)	1¼" Compression	1¼" Female Iron Pipe
RHB40914	1½"	RIGHT (clockwise)	1½" Compression	1½" Female Iron Pipe
RHB40915	2"	RIGHT (clockwise)	2" Compression	2" Female Iron Pipe

NOTE: Stainless steel insert stiffeners are required for use with plastic tubing (CTS) (compression ends only).
 Optional handle available for above ground operation.
 For use on soft K copper tubing and CTS plastic only.

FEMALE TYPE CURB STOPS

Red Hed Ball Curb Stops

Red Hed Ball Curb Stops are precision machined to ensure watertight integrity. They have full-size waterways and heavy castings. They are machined from lead-free bismuth brass CDA No. C89833. During the manufacturing process, the valves are repeatedly inspected and hydrostatically tested to 300 psi.

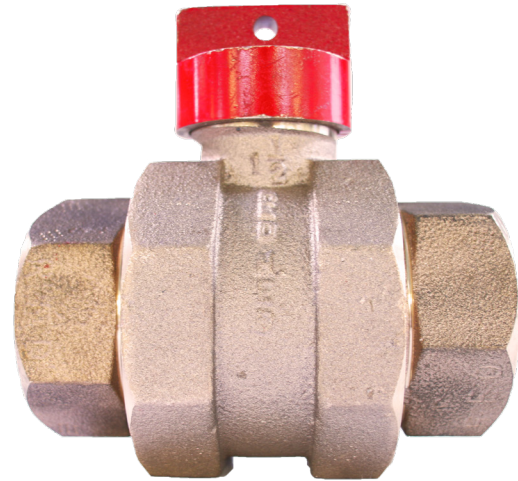

Features:

- Manufactured to ANSI/AWWA C800 Standards
- 80 durometer Neoprene rubber seats that seal in both directions
- Full port clear waterway in all sizes
- Double “O” ring stem seals
- Full lead free brass ball, teflon coated for easy turning
- Open left or right, ¼ turn operation with stop, clearly marked T-head L or R
- Tee-Head Secured with dovetail stem and ball design
- All components of the valve manufactured from Lead Free Brass, Casting Stamped “LF”
- All Cast components poured and manufactured in the USA.
- Easily adaptable female iron pipe ends.

Female Iron Pipe x Female Iron Pipe

PRODUCT NUMBER	SIZE	DIRECTION TO OPEN	INLET	OUTLET
RHB22201	¾"	LEFT (counterclockwise)	¾" Female Iron Pipe (FEIP)	¾" Female Iron Pipe (FEIP)
RHB22202	1"	LEFT (counterclockwise)	1" Female Iron Pipe (FEIP)	1" Female Iron Pipe (FEIP)
RHB22203	1¼"	LEFT (counterclockwise)	1¼" Female Iron Pipe (FEIP)	1¼" Female Iron Pipe (FEIP)
RHB22204	1½"	LEFT (counterclockwise)	1½" Female Iron Pipe (FEIP)	1½" Female Iron Pipe (FEIP)
RHB22205	2"	LEFT (counterclockwise)	2" Female Iron Pipe (FEIP)	2" Female Iron Pipe (FEIP)
RHB22301	¾"	RIGHT (clockwise)	¾" Female Iron Pipe (FEIP)	¾" Female Iron Pipe (FEIP)
RHB22302	1"	RIGHT (clockwise)	1" Female Iron Pipe (FEIP)	1" Female Iron Pipe (FEIP)
RHB22303	1¼"	RIGHT (clockwise)	1¼" Female Iron Pipe (FEIP)	1¼" Female Iron Pipe (FEIP)
RHB22304	1½"	RIGHT (clockwise)	1½" Female Iron Pipe (FEIP)	1½" Female Iron Pipe (FEIP)
RHB22305	2"	RIGHT (clockwise)	2" Female Iron Pipe (FEIP)	2" Female Iron Pipe (FEIP)

NOTE: Optional handle available for above ground operation.

FLARE TYPE CURB STOPS

Red Hed Ball Curb Stops

Red Hed Ball Curb Stops are precision machined to ensure watertight integrity. They have full-size waterways and heavy castings. They are machined from lead-free bismuth brass CDA No. C89833. During the manufacturing process, the valves are repeatedly inspected and hydrostatically tested to 300 psi.

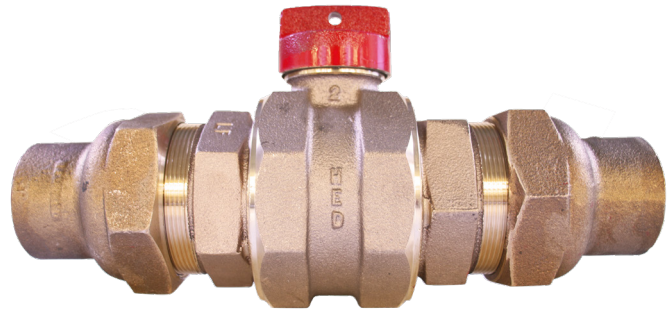

Features:

- Manufactured to ANSI/AWWA C800 Standards
- 80 durometer Neoprene rubber seats that seal in both directions
- Full port clear waterway in all sizes
- Double “O” ring stem seals
- Full lead free brass ball, teflon coated for easy turning
- Open left or right, ¼ turn operation with stop, clearly marked T-head L or R
- Tee-Head Secured with dovetail stem and ball design
- All components of the valve manufactured from Lead Free Brass, Casting Stamped “LF”
- All Cast components poured and manufactured in the USA.
- Easy to install flare ends (industry standard)
- Other End variations available: Flare / Male Iron Pipe, Flare / Female Iron pipe

Flare x Flare

PRODUCT NUMBER	SIZE	DIRECTION TO OPEN	INLET	OUTLET
RHB41501	¾"	LEFT (counterclockwise)	¾" Flare	¾" Flare
RHB41502	1"	LEFT (counterclockwise)	1" Flare	1" Flare
RHB41503	1¼"	LEFT (counterclockwise)	1¼" Flare	1¼" Flare
RHB41504	1½"	LEFT (counterclockwise)	1½" Flare	1½" Flare
RHB41505	2"	LEFT (counterclockwise)	2" Flare	2" Flare
RHB41601	¾"	RIGHT (clockwise)	¾" Flare	¾" Flare
RHB41602	1"	RIGHT (clockwise)	1" Flare	1" Flare
RHB41603	1¼"	RIGHT (clockwise)	1¼" Flare	1¼" Flare
RHB41604	1½"	RIGHT (clockwise)	1½" Flare	1½" Flare
RHB41605	2"	RIGHT (clockwise)	2" Flare	2" Flare

NOTE: For use on soft copper K Tubing, and CTS plastic tubing when using proper CTS Flaring tools. Optional handle available for above ground operation.

COMPRESSION/MALE (MIP) ADAPTERS BRASS FITTINGS

Red Hed Male Adaptors



Features:

- Manufactured to ANSI/AWWA C800 Standards
- Easy to install flare or compression ends (industry standard)
- Full port clear waterway in all sizes
- All components manufactured from Lead Free Bismuth Brass CDA No. C89833, Casting Stamped “LF”
- All Cast components poured and manufactured in the USA.

Compression or Flare x Male Iron Pipe (MIP)

PRODUCT NUMBER	SIZE	TYPE OF PIPE	INLET	OUTLET
RH40201	¾"	Copper Service Tubing or CTS PE Tubing	¾" Flare	¾" Male Iron Pipe
RH402012	¾ x 1"	Copper Service Tubing or CTS PE Tubing	¾" Flare	1" Male Iron Pipe
RH40202	1"	Copper Service Tubing or CTS PE Tubing	1" Flare	1" Male Iron Pipe
RH402021	1 x ¾"	Copper Service Tubing or CTS PE Tubing	1" Flare	¾" Male Iron Pipe
RH40203	1¼"	Copper Service Tubing or CTS PE Tubing	1¼" Flare	1¼" Male Iron Pipe
RH40204	1½"	Copper Service Tubing or CTS PE Tubing	1½" Flare	1½" Male Iron Pipe
RH40205	2"	Copper Service Tubing or CTS PE Tubing	2" Flare	2" Male Iron Pipe
RH40211	¾"	Copper Service Tubing or CTS PE Tubing	¾" Compression	¾" Male Iron Pipe
RH402112	¾ x 1"	Copper Service Tubing or CTS PE Tubing	¾" Compression	1" Male Iron Pipe
RH40212	1"	Copper Service Tubing or CTS PE Tubing	1" Compression	1" Male Iron Pipe
RH402121	1 x ¾"	Copper Service Tubing or CTS PE Tubing	1" Compression	¾" Male Iron Pipe
RH40213	1¼"	Copper Service Tubing or CTS PE Tubing	1¼" Compression	1¼" Male Iron Pipe
RH40214	1½"	Copper Service Tubing or CTS PE Tubing	1½" Compression	1½" Male Iron Pipe
RH40215	2"	Copper Service Tubing or CTS PE Tubing	2" Compression	2" Male Iron Pipe

NOTE: For use on soft copper K tubing and CTS plastic tubing when using proper CTS flaring tools. Stainless steel insert stiffeners are required for use with plastic tubing (CTS) (compression ends only).

COMPRESSION/FEMALE (FEIP) ADAPTERS BRASS FITTINGS

Red Hed Female Adaptors



Features:

- Manufactured to ANSI/AWWA C800 Standards
- Easy to install flare or compression ends (industry standard)
- Full port clear waterway in all sizes
- All components manufactured from Lead Free Bismuth Brass CDA No. C89833, Casting Stamped "LF"
- All Cast components poured and manufactured in the USA.

Compression or Flare x Female Iron Pipe (FEIP)

PRODUCT NUMBER	SIZE	TYPE OF PIPE	INLET	OUTLET
RH41301	¾"	Copper Service Tubing or CTS PE Tubing	¾" Flare	¾" Female Iron Pipe
RH413012	¾ x 1"	Copper Service Tubing or CTS PE Tubing	¾" Flare	1" Female Iron Pipe
RH413021	1"	Copper Service Tubing or CTS PE Tubing	1" Flare	¾" Female Iron Pipe
RH413023	1 x 1¼"	Copper Service Tubing or CTS PE Tubing	1" Flare	1" Female Iron Pipe
RH41303	1¼"	Copper Service Tubing or CTS PE Tubing	1¼" Flare	1¼" Female Iron Pipe
RH41304	1½"	Copper Service Tubing or CTS PE Tubing	1½" Flare	1½" Female Iron Pipe
RH41305	2"	Copper Service Tubing or CTS PE Tubing	2" Flare	2" Female Iron Pipe
RH41311	¾"	Copper Service Tubing or CTS PE Tubing	¾" Compression	¾" Female Iron Pipe
RH413112	¾ x 1"	Copper Service Tubing or CTS PE Tubing	¾" Compression	1" Female Iron Pipe
RH413113	¾ x 1¼"	Copper Service Tubing or CTS PE Tubing	¾" Compression	1¼" Female Iron Pipe
RH413121	1" x ¾"	Copper Service Tubing or CTS PE Tubing	1" Compression	¾" Female Iron Pipe
RH41312	1"	Copper Service Tubing or CTS PE Tubing	1" Compression	1" Female Iron Pipe
RH413123	1 x 1¼"	Copper Service Tubing or CTS PE Tubing	1" Compression	1¼" Female Iron Pipe
RH41313	1¼"	Copper Service Tubing or CTS PE Tubing	1¼" Compression	1¼" Female Iron Pipe
RH41314	1½"	Copper Service Tubing or CTS PE Tubing	1½" Compression	1½" Female Iron Pipe
RH41315	2"	Copper Service Tubing or CTS PE Tubing	2" Compression	2" Female Iron Pipe

NOTE: For use on soft copper K tubing and CTS plastic tubing when using proper CTS flaring tools. Stainless steel insert stiffeners are required for use with plastic tubing (CTS) (compression ends only).

COMPRESSION COUPLINGS BRASS FITTINGS

Red Hed Compression Couplings



Features:

- Manufactured to ANSI/AWWA C800 Standards
- Easy to install flare or compression ends (industry standard)
- Full port clear waterway in all sizes
- All components manufactured from Lead Free Bismuth Brass CDA No. C89833, Casting Stamped "LF"
- All Cast components poured and manufactured in the USA.

Compression x Compression or Flare x Flare

PRODUCT NUMBER	SIZE	TYPE OF PIPE	INLET	OUTLET
RH41201	3/4"	Copper Service Tubing	3/4" Flare	3/4" Flare
RH412012	3/4 x 1"	Copper Service Tubing	3/4" Flare	1" Flare
RH41202	1"	Copper Service Tubing	1" Flare	1" Flare
RH41203	1 1/4"	Copper Service Tubing	1 1/4" Flare	1 1/4" Flare
RH41204	1 1/2"	Copper Service Tubing	1 1/2" Flare	1 1/2" Flare
RH41205	2"	Copper Service Tubing	2" Flare	2" Flare
RH41211	3/4"	Copper Service Tubing	3/4" Compression	3/4" Compression
RH412112	3/4 x 1"	Copper Service Tubing	3/4" Compression	1" Compression
RH41212	1"	Copper Service Tubing	1 1/4" Compression	1" Compression
RH41213	1 1/4"	Copper Service Tubing	1 1/4" Compression	1 1/4" Compression
RH41214	1 1/2"	Copper Service Tubing	1 1/2" Compression	1 1/2" Compression
RH41215	2"	Copper Service Tubing	2" Compression	2" Compression

NOTE: For use on soft copper K tubing and CTS plastic tubing when using proper CTS flaring tools. Stainless steel insert stiffeners are required for use with plastic tubing (CTS) (compression ends only).

LEAD FLANGE ADAPTORS

Red Hed takes the hassle out of lead service replacement. Custom made lead flange adaptors let you use existing corporations and eliminate the need for retapping or line shutdown.

Red Hed lead flange adaptors are manufactured from lead free bismuth brass CDA No. C89833 and are hydrostatically tested to 300 psi.



Features:

- Manufactured to ANSI/AWWA C800 Standards
- Easy to install flare or compression ends (industry standard)
- Use on existing corporation stops
- Adapts to copper or plastic
- Over 200 variations available
- All components of the valve manufactured from Lead Free Brass, Casting Stamped "LF"
- All Cast components poured and manufactured in the USA.
- Available with compression or flare outlet.
- May require a sample of your existing corp or curb to gauge threads and size correctly.

Lead Flange Adaptors

PRODUCT NUMBER	INLET FEMALE THREAD SIZE	OUTLET	THREAD
RH45001 5/8" Lead Size	5/8" = 11 1/16"	3/4" Flare	12
RH45002 5/8" Lead Size	5/8" = 11 1/16"	1" Flare	12
RH45021 MS Size	MS = 1 27/32"	3/4" Flare	12
RH45022 MS Size	MS = 1 27/32"	1" Flare	12
RH45041 Red Hed Size	RH = 2 1/8"	3/4" Flare	12
RH45042 Red Hed Size	RH = 2 1/8"	1" Flare	12
RH45061 Red Hed Oversize	RHO = 2 5/32"	3/4" Flare	12
RH45062 Red Hed Oversize	RHO = 2 5/32"	1" Flare	12
RH45011 5/8" Lead Size	5/8" = 11 1/16"	3/4" Compression	12
RH45012 5/8" Lead Size	5/8" = 11 1/16"	1" Compression	12
RH45031 MS Size	MS = 1 27/32"	3/4" Compression	12
RH45032 MS Size	MS = 1 27/32"	1" Compression	12
RH45051 Red Hed Size	RH = 2 1/8"	3/4" Compression	12
RH45052 Red Hed Size	RH = 2 1/8"	1" Compression	12
RH45071 Red Hed Oversize	RHO = 2 5/32"	3/4" Compression	12
RH45072 Red Hed Oversize	RHO = 2 5/32"	1" Compression	12

NOTE: For use on soft copper K tubing and CTS plastic tubing when using proper CTS flaring tools. Stainless steel insert stiffeners are required for use with plastic tubing (CTS) (compression ends only).

BRONZE METER HARDWARE

Bronze Meter Flanges & Downsizing Hardware

Red Hed offers high-quality hardware for both straight connecting and downsize connecting of piping and meters. Any of your meter-connecting requirements can be met using our Lead-Free Downsizing Adaptors.

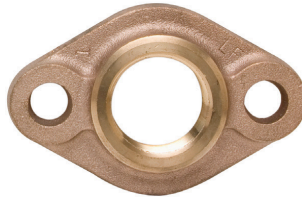

Features:

- Manufactured for use with AWWA C700 cold water meters
- Conforms to AWWA C800 standards
- Has "LF" cast into body for identification

PRODUCT NUMBER	OLD METER SIZE	NEW METER SIZE	CONNECTION TYPE	QUANTITY TO USE
RH130402P	1½" - Thermal	1"	Screw End Standard Style	1 Pack
RH131501P	1½" - Thermal	1"	Screw End Standard Style	1 Pack
RH130502P	2" - Thermal	1"	Screw End Standard Style	1 Pack
RH130201P	2" - Thermal	1"	Screw End Standard Style	1 Pack
RH13014	1½" - Thermal	1½"	Screw Style Meter Coupling	3 Pieces w/ Gasket
RH13015	2" - Thermal	2"	Screw Style Meter Coupling	3 Pieces w/ Gasket
RH200402P	1½" - Flanged	1"	Oval Flange	1 Pack
RH200404P	1½" - Flanged	1½"	Oval Flange	1 Pack
RH200504P	2" - Flanged	1½"	Oval Flange	1 Pack
RH200505P	2" - Flanged	2"	Oval Flange	1 Pack
RH1430	1"	¾"	Meter Downsize Adaptor	2 Pieces
RH1412	1"	5/8" x ¾"	Meter Downsize Adaptor	2 Pieces
RH1402	1"	5/8"	Meter Downsize Adaptor	2 Pieces
RH1425	¾"	5/8" x ¾"	Meter Downsize Adaptor	1 Piece

NOTE: Packs include gaskets, bolts and nuts.
See Meter Downsizing Guide for more information.

SPACE SAVER FLANGES

Downsizing with Space Saver Flanges is the answer to costly meter replacement.

Our patented Space Saver Flange revolutionizes the process of replacing a large meter with a smaller meter. Originally developed for water meter downsizing, the space saver offers a concentric reducer in a short lay-length, dramatically reducing the amount of space and piping needed to downsize. You save work, time, money, and space.

Features:

- Saves work, time, money, and space
- Available in 31 standard sizes
- Manufactured in special sizes up to 24" (upon request)
- #125/250 configurations available
- special thicknesses and drilling patterns available (upon request)
- Shipped bare, ready to install
- 12 o'clock notch helps with installation
- Comes fully assembled with studs, nuts, and gaskets, so you don't have to worry about special hardware

Materials:

- Flange: Cast Iron
- Studs: B-7 Hardened Steel with 2H hexnuts & nuts
- Gasket: Matte finish red rubber standard, other materials available upon request
- Special coatings available upon request & materials

Contact a Red Hed representative for help with your application today!

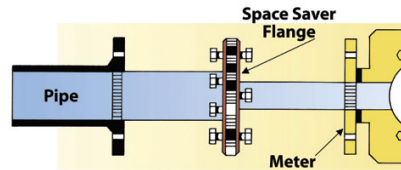
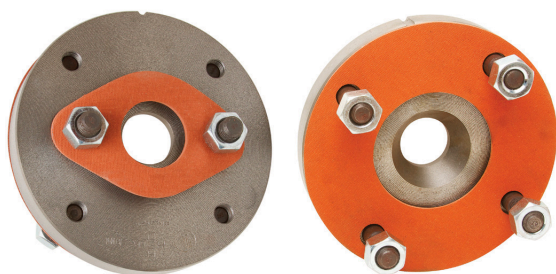

PRODUCT NUMBER	SIZE	DESCRIPTION	FLANGE THICKNESS	APPROX. WT. (LBS)
RHFLSP13062	2" x 2"	2 Bolt Hole x 4 Bolt Hole	13/16"	9
RHFLSP130715	3" x 1 1/2"	Space Saver	1"	13
RHFLSP13072	3" x 2"	Space Saver 2 Bolt Hole	1"	13
RHFLSP130724	3" x 2"	Space Saver 4 Bolt Hole	1"	13
RHFLSP130915	4" x 1 1/2"	Space Saver 2 Bolt Hole	1 3/16"	22
RHFLSP13092	4" x 2"	Space Saver 2 Bolt Hole	1 3/16"	22
RHFLSP130924	4" x 2"	Space Saver 4 Bolt Hole	1 3/16"	22
RHFLSP130925	4" x 2 1/2"	Space Saver	1 3/16"	22
RHFLSP13093	4" x 3"	Space Saver	1 3/16"	22
RHFLSP131115	6" x 1 1/2"	Space Saver	1 3/16"	33
RHFLSP13112	6" x 2"	Space Saver 2 Bolt Hole	1 3/16"	33
RHFLSP131124	6" x 2"	Space Saver 4 Bolt Hole	1 3/16"	33
RHFLSP131125	6" x 2 1/2"	Space Saver	1 3/16"	33
RHFLSP13113	6" x 3"	Space Saver	1 3/16"	33
RHFLSP13114	6" x 4"	Space Saver	1 3/16"	31
RHFLSP13115	6" x 5"	Space Saver	2 1/4"	48
RHFLSP13132	8" x 2"	Space Saver 2 Bolt Hole	1 13/16"	48
RHFLSP131324	8" x 2"	Space Saver	1 3/16"	48
RHFLSP13133	8" x 3"	Space Saver	1 3/16"	47
RHFLSP13134	8" x 4"	Space Saver	1 3/16"	47
RHFLSP13135	8" x 5"	Space Saver	1 3/16"	47
RHFLSP13136	8" x 6"	Space Saver	1 3/16"	44
RHFLSP13163	10" x 3"	Space Saver	1 7/16"	76
RHFLSP13164	10" x 4"	Space Saver	1 7/16"	75
RHFLSP13165	10" x 5"	Space Saver	1 7/16"	74
RHFLSP13166	10" x 6"	Space Saver	1 7/16"	74
RHFLSP13168	10" x 8"	Space Saver	1 7/16"	73
RHFLSP13194	12" x 4"	Space Saver	1 1/2"	125
RHFLSP13196	12" x 6"	Space Saver	1 1/2"	115
RHFLSP13198	12" x 8"	Space Saver	1 1/2"	100
RHFLSP131910	12" x 10"	Space Saver	1 1/2"	95

REDI-JACK PIPE SUPPORT

An adjustable ready-to-use stand designed to meet all your piping support needs!

Red Hed provides a unique product perfect for supporting large water meters and backflow devices. The Redi-Jack Pipe Support, unlike other designs, features a one-piece support plate and a support tube that can be cut to size in the field. Both the support plate and the base plate are drilled so that the stand can be securely anchored. Red Hed's quality construction, including black rustproof paint, assures long-lasting service.

Features:

- Easy, adjustable installation
- No welding necessary
- One-piece support plate
- Comes as a complete assembly
- Provided with rustproof finish
- Support plate available in 2" to 24" sizes
- Standard 3 ft. height; additional heights available upon request

Materials:

- Support Plate: Cast ductile iron ASTM A-536
- Adjustment Nut: 1"–8" finish nut plated ANSI-ASME B-18-2-2 or (Heavy 304/316ss available)
- Adjustment Stud: 1" rolled threads steel plated ASTM A-307 (available in 304/316ss when specified)
- Main Support Tube: Steel pipe, Schedule 40 ASTM A-53 (available in 304/316ss when specified); 1" for 2-12", 1¼" for 14-24"
- Base Plate: Hot rolled ¼" steel ASTM A-36 (available in 304/316ss when specified); 6x6" for 2-12", 8x8" for 14-24"

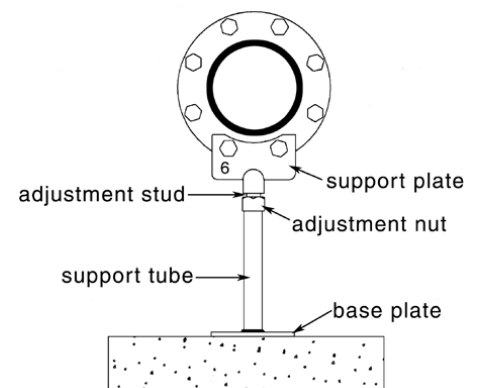
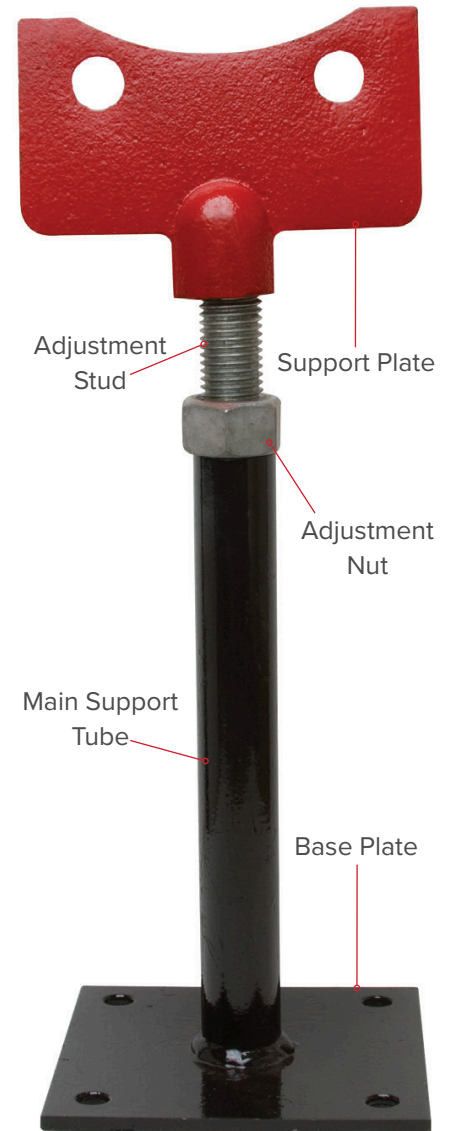

PRODUCT NUMBER	SIZE
RHPS0236	2"
RHPS0336	3"
RHPS0436	4"
RHPS0636	6"
RHPS0836	8"
RHPS1036	10"
RHPS1236	12"
RHPS2436	14-24" (uses 1¼" main support tube)

SERVICES

We Can Rebuild Your Old Drilling & Tapping Machine For a Fraction of the Cost of a New Machine!

Red Hed Manufacturing can rebuild your drilling and tapping machine at a fraction of the cost of a new one.

Red Hed Manufacturing repairs and reconditions drilling and tapping machines to their original machine specifications, assuring that reworked machines will perform as good as new. Our tool-making craftsmanship and extensive parts inventory eliminates costly downtime. This service includes a complete teardown of the machine, new parts as needed, sandblasting, greasing and repainting.

Red Hed Manufacturing rebuilds brand name drilling and tapping machines, including:

- Romac
- Mueller
- Ford
- Reed

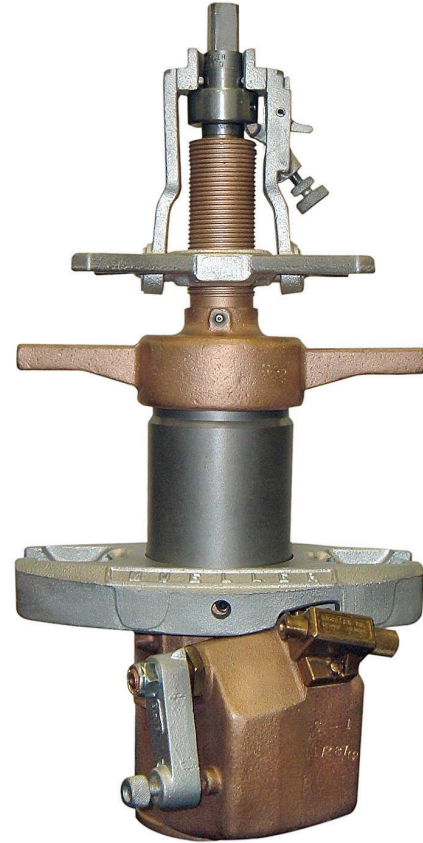

Tapping Machine after it has been completely rebuilt!

Save Money! Have Your Drilling & Tapping Bits Resharpended!

Why spend costly dollars on new drilling and tapping bits when Red Hed Manufacturing can resharpen your used and worn tapping bits at a fraction of the cost? This is one more service you can count on when you do business with Red Hed Manufacturing.



SERVICES

Machine Shop Capabilities and Service

Red Hed Manufacturing has true “Job Shop” capabilities as well as the ability to provide volume production! We pride ourselves on our staff, equipment and skill. Put us to work for you!

- CNC Turning Centers for high thru-put rate; accuracy = .001"
- Turret Lathes for turning and boring.
- Boring capability to 20.000" I.D.
- Bridgeport Milling Machines for custom work.
- Broaching & Gang Drilling Centers.
- Radial Drilling Centers.
- Pipe Lathes for threading & turning spool pipe.
- Band Saws for raw material cutting & shaping.
- Certified Brazing, Soldering and MIG-Arc welding.
- Cut-Off Saws for large jobs.
- Surface Grinding to a quality finish.
- Custom Toolmaker Shop for specialty jobs & custom work!
- Hydraulic Pressure Testing for water meters, valves & fittings!
- State-of-the-art Solidworks System for your prints & design reading.
- Drill bit & Tap-Drill bit sharpening systems.

Our experienced staff can help turn your ideas into reality! We pride ourselves on our ability to meet your deadlines and provide quality craftsmanship in every project we undertake.

Locally:

- Enjoy a full sized Job Shop in your backyard!
- Talk to representatives familiar with industry needs.
- Bring your part or tool to us, or ship it to us to examine, measure and gauge.

Nationally:

- Meeting National standards daily! Our products meet UL & FM certifications.
- Our waterworks brass conforms to NSF-60 & 61 - LEAD-FREE stipulations.
- All waterworks products are made to ANSI/AWWA C800 standards.
- Daily parcel and pallet shipments across the country.

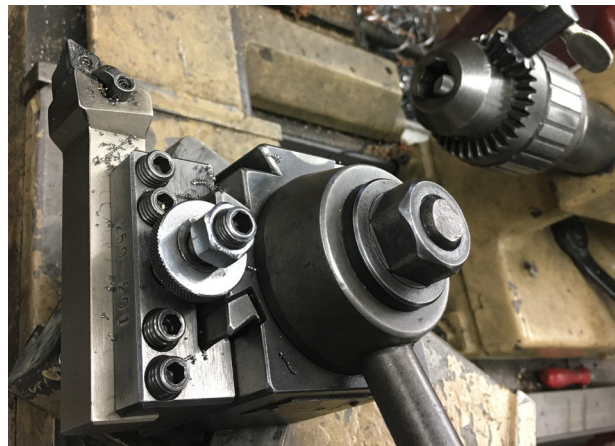

TEAM
RED
HED 
BRASS MANUFACTURING

RED HED MANUFACTURING COMPANY

Division of Everett J. Prescott, Inc.

38 Albion Road, Route 123, Lincoln, RI 02865

401-333-1317 • 1-800-356-8605 • FAX: 401-333-9035

sales@redhedri.com • www.redhedri.com